

Advanced IP Phone with 3 lines & HD voice

- TI TITAN chipset and TI voice engine
- 3 VoIP accounts, 132x64 graphic LCD
- HD Voice: HD Codec, HD speaker, HD handset
- 2xLAN, PoE, headset, expansion module



Yealink SIP-T26P is an advanced IP phone which designed for maximum productivity and efficiency in the everyday business environment. It is equipped with the leading TI TITAN chipset, offers high definition voice quality through TI voice engine, HD handset, HD speaker and HD codec (G.722). Built-in 10 DSS keys for programmed as the IP-PBX features like BLF/BLA, intercom, call pickup etc. Six navigation keys and four soft keys help you using the phone easily. Ten dedicated functional keys provide you with direct access to the functions for audio and call control. Moreover, SIP-T26P has the rich external interfaces including 2xLAN, PoE, headset and expansion module ports.

Enterprise HD IP Phone

SIP-T26P

Phone Features

- 3 VoIP accounts, hotline, emergency call
- Call waiting, call transfer, call forward
- Hold, mute, flash, auto-answer, redial
- 3-way conference, DND, speed dial
- XML Phonebook search/import/export
- Black list, call history (100 entries)
- Volume adjustment, ring tone selection
- Tone scheme, System log
- Multi-language (more than 20)
- Supports up to 6 expansion modules

IP PBX System Integration

- Dial plan, dial-now
- SMS, Voicemail, MWI
- BLF/BLA, intercom, paging
- Call park, call pickup
- Distinctive ringtone

Codecs and Voice Features

- Wideband codec: G.722
- Narrowband codec: G.711, G.723.1, G.726, G.729AB
- VAD, CNG, AEC, PLC, AJB, AGC
- Full-duplex speakerphone with AEC

Network Features

- SIP v1 (RFC2543), v2 (RFC3261)
- NAT Traversal: STUN mode
- DTMF: In-Band, RFC2833, SIP Info
- Proxy mode and peer-to-peer SIP link mode
- IP Assignment: Static/DHCP/PPPoE
- TFTP/DHCP/PPPoE client
- Telnet/HTTP/HTTPS server
- DNS client
- NAT/DHCP server

Management

- FTP/TFTP/HTTP/PnP auto-provision
- Configuration: browser/phone/auto-provision
- Direct IP call without SIP proxy
- Dial number via SIP server
- Dial URL via SIP server

Security

- HTTPS (server/client)
- SRTP (RFC3711)
- Transport Layer Security (TLS)
- VLAN (802.1 pq), QoS
- Digest authentication using MD5/MD5-sess
- Secure configuration file via AES encryption
- Phone lock for personal privacy protection
- Admin/user configuration mode

Physical Features

- TI TITAN Chipset
- 132x64 graphic LCD
- 45 keys including 13 programmable keys
- 1xRJ9 (4P4C) handset port
- 1xRJ9 (4P4C) headset port
- 2xRJ45 10/100M Ethernet ports
- 1XRJ12 (6P6C) expansion module port
- Power adapter: AC 100~240V input and DC 5V/1.2A output
- Power over Ethernet (IEEE 802.3af)
- Power consumption: 1.6~2.6W
- Net weight: 1.05KG
- Dimension: 273x204x42MM
- Operating humidity: 10~95%
- Storage temperature: up to 60°C

Package Features

- Qty/CTN: 5 PCS
- N.W/CTN: 7.87KG
- G.W/CTN: 9.00KG
- Measurement: 0.073CMB
- Carton Meas: 470x287x222MM

Certifications

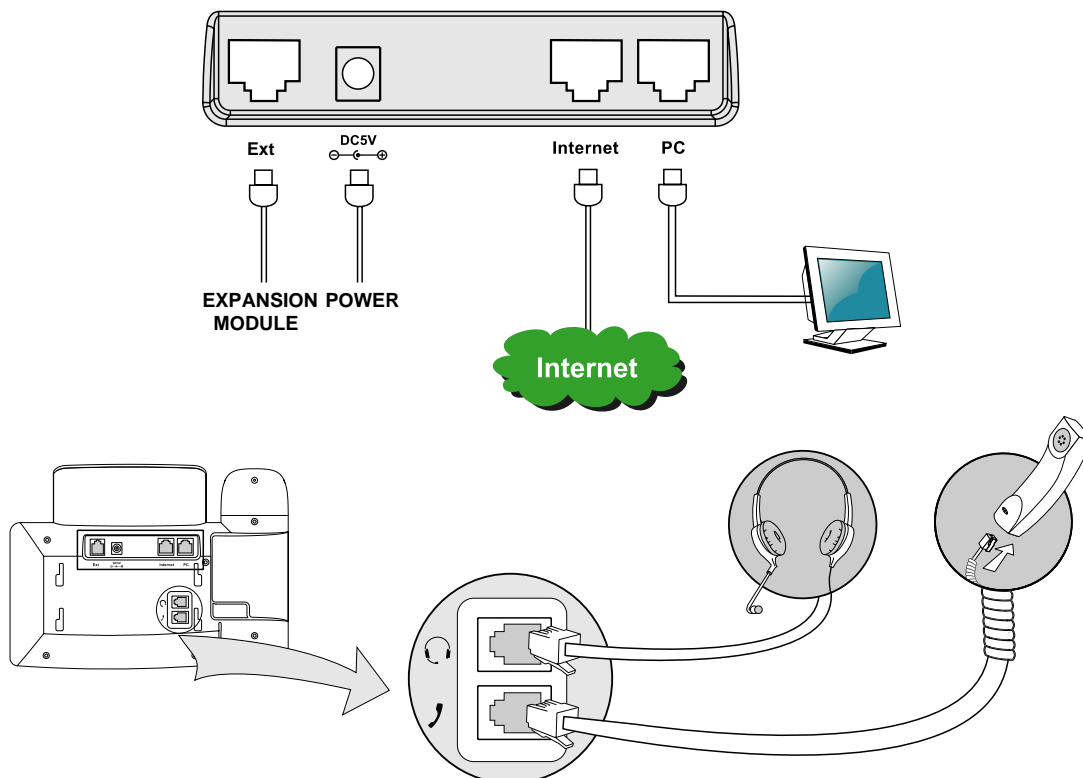

Australia & New Zealand

Tel: +61 3 8562 9000 FreeCall: 1800 817 807
Email: sales@alloy.com.au Web: www.alloy.com.au

AlloyCP - U.S.A.

Tel: +1 703 6510 371 Tollfree: 888 895 8256
Email: sales@alloycp.com Web: www.alloycp.com